

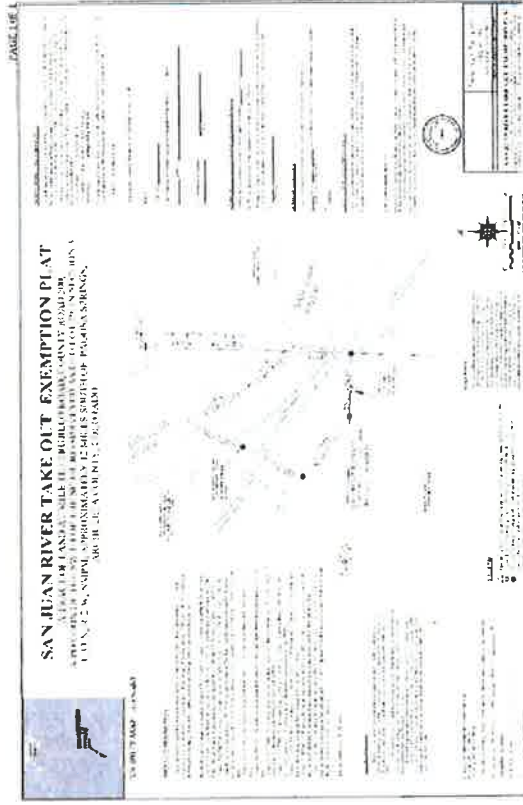

VICINITY MAP



PROPERTY PLAT



BOAT RAMP CONCEPT
SAMPLE PHOTO

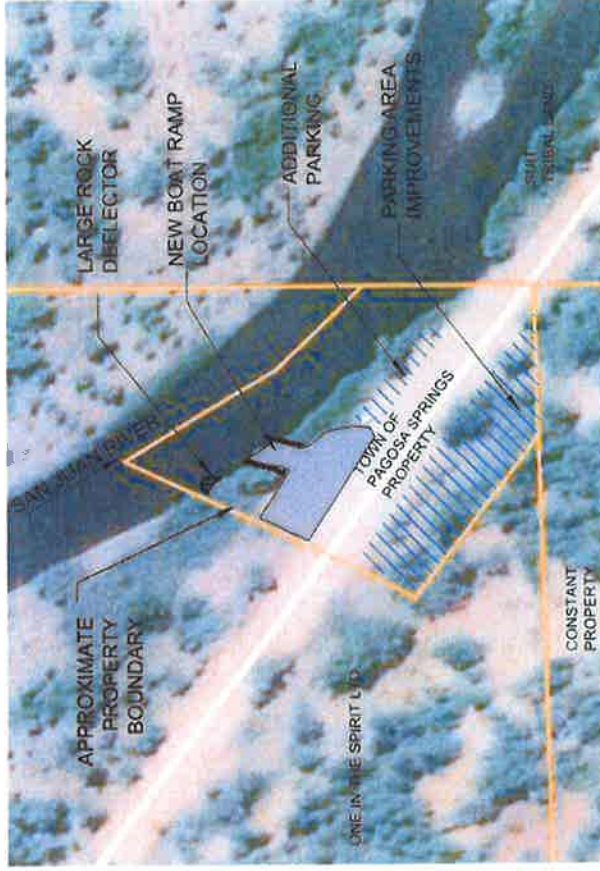

CONCEPT PLAN VIEW

MESA CANYON BOAT RAMP AND PARKING IMPROVEMENTS
PROJECT MAP AND CONCEPT PLANS
Non-Motorized Trails Grant Application

MESA CANYON BOAT RAMP/PARKING AREA Preliminary Budget
Preliminary Engineers Estimate 1.22.21

TASK	Item	Unit	Estimated Quantity	Cost Per Unit	Subtotal
Task 1: Project Design and Permitting (2) Boat Ramps					
	Survey and Preliminary Design of Project Elements		1	\$3,000.00	\$3,000.00
	Final Design and Construction Documents		1	\$8,000.00	\$8,000.00
	Permit Approvals		1	\$3,000.00	\$3,000.00
	<i>Subtotal Task 1</i>				\$14,000.00
Task 2: Construction of Mesa Canyon Boat Ramp					
	Mobilization	Lump Sum	1	\$3,500.00	\$3,500.00
	Large Rock, 4-5 ft.	Each	50	\$130.00	\$6,500.00
	Small Rock Rip Rap Deliver and Place	CY	35	\$70.00	\$2,450.00
	Place large boulders with excavator with thumb	Each	50	\$100.00	\$5,000.00
	Construct Boat Ramp & Scour Feature	Lump Sum	1	\$3,500.00	\$3,500.00
	Parking Lot Clear and Grub	Acre	0.25	\$5,000.00	\$1,250.00
	3/4" minus Topping (Class V) Deliver and Place	CY	150	\$80.00	\$12,000.00
	Parking Lot Base Course Deliver and Place	CY	150	\$60.00	\$9,000.00
	Install willow transplants	Each	20	\$40.00	\$800.00
	River Channel Shaping (CY)	CY	120	\$10.00	\$1,200.00
	Construction Contingency	Lump Sum	1	\$3,000.00	\$3,000.00
	Construction Management, Surveys and Contractor Quality Control	Lump Sum	1	\$5,000.00	\$5,000.00
	<i>Subtotal Task 2</i>				\$53,200.00
Task 3: Project Signage/Fencing					
	Property Boundary/ Road Crossing/Site Information	Lump Sum	1	\$2,500.00	\$2,500.00
	Fence	LF	150	10	\$1,500.00
	<i>Subtotal Task 3</i>				\$4,000.00
Task 4: Project Management					
Total					\$71,200.00

Source of Funds (Cash)							Total Funding
great outdoor fund	Town of Pagosa Springs	Friends of the Upper San Juan	County	Tourism	CPW Grant	SW/RE In Kind	
\$2,000.00	\$6,000.00	\$5,000.00	\$10,000.00	\$20,000.00	\$10,000	\$14,000 In Kind	
	\$1000 In Kind						
	\$850 In kind						
	\$850 In kind						
	\$1500 In kind						
\$2,000.00	\$10,200.00	\$5,000.00	\$10,000.00	\$20,000.00	\$10,000.00	\$14,000.00	\$71,200.00